

FACADESXi WATERSHIELD-CB SYSTEM

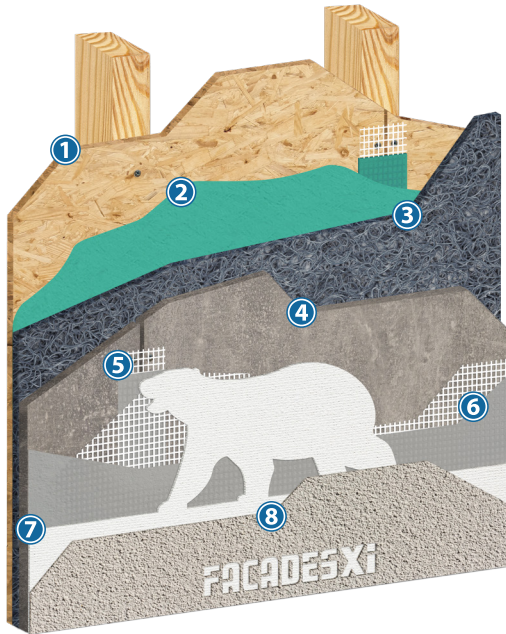

SYSTEM DESCRIPTION

FacadesXi Watershield-CB System is a tested and engineered ultra-high impact and puncture resistant cement board wall assembly with a continuous air and water barrier and a drainage plane. The system gives the look and feel of a traditional stucco assembly with faster installation and less labor.

Optional Advantages Upgrades

- Xi Advantage: EPS, XPS or Polyisocyanurate Insulation Board
- Consistency Enhancement: Xi-Alkali Resistant Primer
- Elastomeric finish coat bridges hairline cracks

COMPONENTS

- ① **Substrate**
 - ASTM C1177 Glass mat gypsum sheathing
 - ASTM C1325 Cement Board
 - ASTM C79/C1396 exterior gypsum sheathing
 - Exposure I or exterior plywood (Grade C/D or better)
 - Exposure I OSB
 - Poured concrete or concrete masonry (CMU)
- ② **WaterShield Water and Air Barrier Assembly**
 - WaterShield Water & Air Barrier
 - WaterShield Flashing Tape
 - WaterShield Joint Mesh
 - FXI FlashFill

Must be covered by a code compliant building paper
- ③ **Means of Drainage – a ventilated space to provide optimal drainage of the assembly**
 - Drainage Mat
 - Vertical Ribbons of Adhesive
 - Tyvek Stuccowrap or equal
- ④ **ASTM C1325 Exterior Cement Board – Impact resistant and labor reducing**
 - PermaBase by National Gypsum
 - Equal
- ⑤ **Cement Board Joint Coating – for control of movement between boards**
 - Xi-Mesh Reinforcing mesh
 - Xi-Acrylic Base Coat or Xi-Dry Acrylic Base Coat
- ⑥ **Cement Board Coating: Protection and crack resistance layer**
 - Xi-Mesh Reinforcing mesh
 - Xi-Acrylic Base Coat or Xi-Dry Acrylic Base Coat
- ⑦ **Primer – for decreased efflorescence and highest finish coat aesthetic performance**
 - Xi-Alkali Resistant Primer
- ⑧ **Finish Coat – Integrally colored and textured. Unlimited color selection, dirt pick up resistant**
 - Xi-Textured Acrylic Finish
 - Xi-Flexx Finish

Consult system specifications for exact component options.

USES

Exterior, interior, high impact requirement, new, retrofit, residential, multi-family, commercial, Panelized, institutional, hotels, hospitals, retail centers, schools, condominiums, and government facilities.

COMPLIANCE APPROVALS

Acceptance Criteria AC 3/8" Cement Board Coating Systems.

PermaBase UL Evaluation Report ER22158-01.

Non-combustible and Fire resistant assemblies.

ADVANTAGES

- Impact resistant
- Puncture resistant
- Fluid applied air/water-resistive barrier
- EPS shapes for architectural details
- No Specialized Labor required for Cement board installation
- Reduced Labor
- Shorter construction schedule
- Lower Cladding Weight for decreased structural requirements
- Non-combustible and Fire resistant assemblies available
- Energy Efficient with XI Option
- Fully tested, building code compliant

DESIGN CONSIDERATIONS

- All products must be installed in accordance with the applicable building code and manufacturers instructions. Follow FACADESXi Watershield-CB System specification for installation instructions.
- Maximum allowable deflection L/360.
- The design wind load shall be determined by the structural engineer and the Cement Board Manufacturer.
- Load roofs and install interior gypsum prior to installation of the Cement Board System.
- All penetrations shall be properly treated, flashed and/or sealed using approved installation designed for water drainage to the exterior of the wall.
- Control joint placement per system specifications.
- Expansion joints are per project design; at floor line, dissimilar substrates, and through wall expansion joints. Design and location are the responsibility of the design professional.
- Framed walls must terminate stucco a minimum of 4 inches above grade, 2 inches above finished grade, or as specified by local code.
- Sealant joints shall be detailed and installed per sealant manufacturer's recommendations.
- Slope is required on all horizontal surfaces greater than 1".
- Optional plant-ons may be used to add architectural detailing.
- Sheathing must be covered with Watershield-Xi other code approved water-resistive barrier.

LIMITATIONS

- The system is generally recommended for low rise construction and commercial construction less than 5 stories. See wind load data and verify requirements.
- Minor cracking is possible at cement board joints.
- Ghosting of fasteners is possible during certain temperatures and humidity.
- The cement board basecoat surface must be in plane for the for best aesthetics. Outside of the limitations may cause visible irregularities in the finished wall surface. Heavy texture finishes and or 2 layers of base coat will minimize these effects. The base coat cannot be used in thicker applications to level out the cement board.
- For use on vertical above grade services. Do not use below grade or horizontally.
- Control joints and expansion joints are required as listed in the specifications.
- Maintenance is required with periodic cleaning, repair of cracks and impact damage, if they occur, and/or recoating to enhance appearance of weathered finish.
- Dark colors show more efflorescence and imperfection in the stucco base coat compared to light colors. With Foam Shapes, select a color with a light reflectance value (LRV) of 20 percent or higher.
- All flashing should be installed per codes prior to the installation of system.
- Avoid working in direct sunlight.
- Ambient and surface temperature must remain above 40°F (4°C) for FACADESXi Materials.
- Protect applied product from inclement weather until dry.
- Watershield should not be left exposed more than 6 months.

This system bulletin is not to be used as an application guide, See System specifications, details, and product datasheets for specific installation information.

Watershield-CB SB 07/06/2021